

# CONNECTIONS

*Together, transforming the experience of aging.®*

A PUBLICATION OF KENDAL®-CROSSLANDS COMMUNITIES

FALL / WINTER 2014-2015

## Stewards of Children— The Stars of Tomorrow

Stewardship can be defined as caring for something worth caring for. The children of the Kendal-Crosslands Communities Early Childhood Development Center are certainly that. They are also future stars—not only because some of the children whose little feet once frequented the Center's halls are now KCC staff members, they are also beneficiaries of the Keystone STARS program.

Created specifically to support early learning programs in Pennsylvania, Keystone STARS improves the quality of childhood development through Standards, Training/professional development, Assistance, Resources and Support. The program recognizes continuous quality improvement efforts in early learning in Pennsylvania. Early learning programs can earn from a STAR 1 to a STAR 4 level. At each level, programs have to meet certain research based quality standards that provides the foundation for accreditation.

KCC's Center has reached the STAR 2 level and is recognized by its fellow centers in the area for its high standards of care. KCC anticipates reaching STAR 4 level in the near future. Reaching higher STAR levels provides additional resources for the Center, including learning tools in areas such as science and math, toys and electronics.

KCC has had a child development center for over 20 years and today there are 16 children. The Center provides wonderful learning and caring spaces for children from toddler stage as they move forward to kindergarten. Beyond the STARS however, there is a place that's even more precious and that is the intergenerational experiences between the children and residents. Every week, there are opportunities for fellowship between the children and residents. For example, for shared birthday parties the children make birthday cakes, hats and cards for residents. And when the children learn to swim, residents who frequent the pool are more than willing to be their teachers. KCC's little stars are not inhibited by their obvious distance in years but easily joined by a spirit that is delighted with a simple hello, sharing a smile, friendship, and care.



**Upcoming Events—**  
Visit us in the New Year!

**Group Information Sessions:**

January 14

Crosslands

February 16

Kendal at Longwood

Check out our website  
for additional events  
throughout the year

**KCC.Kendal.org**



### INSIDE:

Message from the CEO 2

Environmental Stewardship 2

The Discover Program 3

Resident Profiles 4

Featured Home 5

Arboretum Fund 5

## A Letter from The Chief Executive Officer...

Dear Friends,

Simplicity, Peace, Integrity, Community, Equality, and Stewardship—S.P.I.C.E.S. are some of the Quaker testimonies at the center of life at Kendal-Crosslands Communities. And, just as spices flavor our food so do the 'SPICES' flavor the lives of the residents and staff.

Described briefly: Simplicity—as an early Quaker, John Woolman, he lived simply, that others may simply live. Peace—practice nonviolent ways of dealing with others in our daily lives. Integrity—be clear and honest with yourself and others in all dealings. Equality—there is that of a divine spirit in everyone and all people are welcomed and treated equally. Community—responding to the needs of others. And lastly, Stewardship—taking care of what has been given to us, responsibility for all the earth and for future generations as well.

In this edition of Connections, you'll discover ways in which residents and staff are stewards of the environment, children, friends with challenges, in our homes, and in our work. We welcome your stewardship and encourage you to talk to us further about the ways in which your interests and the communities' resources may connect.

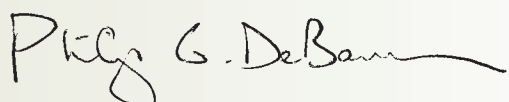

Phil DeBaun, Chief Executive Officer



## Stewardship... The Environment

In 1681, William Penn specified that settlers coming to the lands granted to him by English King Charles II (Charles called it "Pennsylvania") must preserve one acre of trees for every five acres cleared. Their descendants extended Penn's farsighted conservation measures by planting and studying collections of trees.

Nearly 300 years after Penn, it's not surprising that Kendal-Crosslands Communities still maintains a focus on sustaining the natural environment. KCC's 500-acre Arboretum campus is surrounded by forests, meadows, tranquil water features, luscious manicured gardens, hiking trails and rolling hills. Preserving the campus' capacity to sustain and inspire, along with nature that nurtures, requires creative stewardship.

Recently, the National Wildlife Federation (NWF) designated KCC's campus as a Certified Wildlife Habitat site. NWF officially recognized the efforts of the Community to create outdoor

spaces that improve habitats for birds, butterflies, frogs and other wildlife by providing essential elements needed by all wildlife—natural food sources, clean water, cover and places to raise young.



## Stewardship... The Discover Program

The Chester County Intermediate Unit's Discover Program helps students with disabilities discover the possibilities their futures hold. It's a comprehensive work-based learning program that prepares the high school students to transition from school to adult life. Kendal-Crosslands has actively participated in this program for 20 years. "Mr. Dan," as he is fondly known by the student workers (aka Dan



Poe of Crosslands dining), has had students working with him for many years and has seen a change in their self-confidence from when

they first walk in the door to when they graduate. The students rotate within the dining and laundry departments at both Kendal at Longwood and Crosslands. With the help from their mentors and job coaches, they acquire new skills with the aim of being gainfully employed upon graduation. Vernon Barrett, Laundry Manager at Kendal at Longwood, says that he and his staff also learn a great deal from the students. Several students, upon graduation, have been employed by KCC.



We invite you to experience firsthand what it's like to live in the community and discover all that Kendal Crosslands has to offer. Come and when you visit, pack your walking shoes and explore over 7 miles of hiking trails. Bring your appetite and enjoy delicious meals with resident hosts. Join in on resident programs, activities, and cultural happenings. Explore the surroundings and all that the historic Brandywine Valley has to offer. But most of all, bring yourself and discover life at Kendal-Crosslands Communities. If you would like to participate in the Try Us program, please contact us at 800-216-1920.

**1.800.216.1920 • [KCC.Kendal.org](http://KCC.Kendal.org)**

*Try Us...*  
**FOR A SHORT STAY**



## Residents

### Meet Lou and Carolyn Wonderly

The Wonderlys were initially residents of Cartmel and then moved to Crosslands in 2010. Prior to joining the KCC community, they lived in Unionville for over 32 years. They have long been stewards for the community at large. Lou is active, through his church, with affordable housing initiatives, specifically facilitating the creation of Luther House in Jennersville, Pa. Carolyn volunteers with the Needlework Guild Association providing new clothing, linens and toiletries to nine various charities. Every Friday for the past 22 years, Carolyn had volunteered at the Alfred I. duPont Hospital for Children in Wilmington, Del. Living at KCC has given Lou and Carolyn even more opportunities to be active in the community without the burden of maintaining a home. They have one son who lives in Germany and recognize that an additional benefit of living at Crosslands is knowing their son won't have the worry about them.



### Meet Kathleen (Kathy) Giedzinski

Kathy lived in Pocopson, Pa., and the surrounding area for more than 30 years and moved to Kendal at Longwood just a few months ago. But, Kathy knew how to work here before she knew how to live here. For five years, Kathy worked part time at KCC as an every other weekend receptionist and sometimes during the week. She says



that being a resident is a little different from being an employee. But her fellow neighbors and friends quickly helped her become acclimated. They invited her to dinner and she says she never feels alone. Kathy and her husband Hank were on the wait list to move to KCC because they knew this is where they wanted to be. Hank has since passed away, but Kathy is carrying out their plan. Her stewardship is volunteering as a hospice caregiver. Her three children and four grandchildren keep her very busy, too. She loves to hike, and she says she is hoping to be on the trails at Kendal very soon.

## Featured Home

### Expanded Two Bedroom Apartment—Crosslands

Located exclusively at Crosslands, this beautiful apartment home is approximately 1,133 square feet. There are only nine of this floor plan layout on the campus, so, if it appeals to you, don't hesitate, contact us and come see it! Spacious, open living rooms, open and/or enclosed balconies, two bedrooms, laundry, multiple closets and airy kitchens are just some of the attractive features. Give us a call, come visit and warm up with a cup of coffee. You'll love your new home!

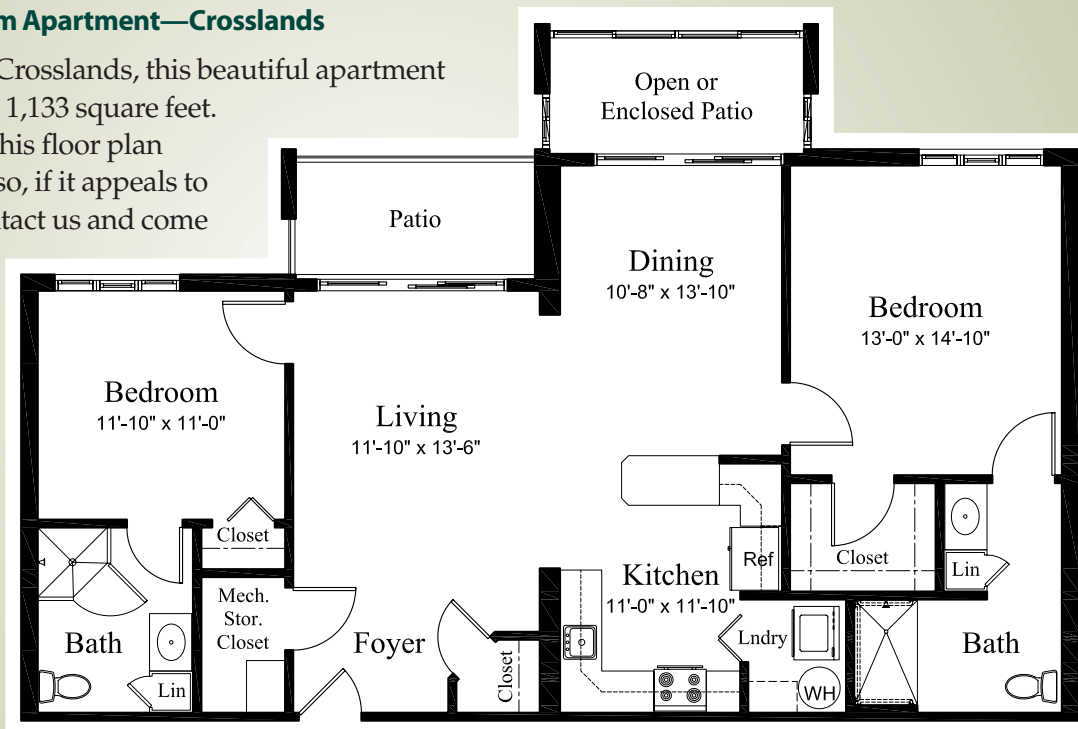

## New Arboretum Fund Beautifies KCC's Campuses

When you think of stewardship, you may think of protecting the environment or you may think of managing financial resources. The Kendal-Crosslands Arboretum Fund epitomizes both types of stewardship. In February 2013, KCC's campus was accredited as an arboretum that includes hundreds of mature trees. In March 2014, the Arboretum Fund was created to accept charitable donations.

Gifts to the Fund support acquisition and care of new trees, and gifts of all sizes are appreciated and are tax-deductible to the full extent of the law. For a donation of \$500 or more, a tree can be planted in honor or memory of a loved one. Kendal-Crosslands Arboretum Committee members are pleased to work with anyone interested in donating a tree and to help you select from a variety of trees on the committee's wish list that includes native species likely to add variety to the arboretum. The names of those honored may appear on a tree label, and a notation of all gifts will be made in the Tree Gift Book in the libraries at Kendal at Longwood and Crosslands.

Philanthropy has a long history at KCC, and now a dedicated staff member manages the organization's fundraising efforts. Stephanie Cory joined the organization as Director of Philanthropy in July.



With Stephanie here, you will be hearing more about philanthropy and how important it is to the community. Her role is to manage fundraising for all four campuses and she is the person to talk to if you're interested in making a charitable gift. Stephanie can provide background about the variety of funds to choose from, as well as creative ways to make a gift, such as through stock or a charitable gift annuity.

For more information about sponsoring a tree, please contact Casey Groff, KCC's Horticulturist, at (610) 388-5558 or [cgroff@kal.kendal.org](mailto:cgroff@kal.kendal.org). Questions about all other donations can be directed to Stephanie Cory, Director of Philanthropy, at (610) 388-5528 or [scory@kal.kendal.org](mailto:scory@kal.kendal.org).

# KENDAL-CROSSLANDS® *Communities*

*Together, transforming the experience of aging.®*

P.O. Box 100 • Kennett Square, PA 19348

**KCC.Kendal.org**

Nonprofit Org.  
U.S. Postage  
PAID  
West Chester, PA  
Permit #418

Phil DeBaun, Chief Executive Officer  
610-388-5614

Meg Lemley, Chief Operating Officer  
610-388-5512



Please recycle this newsletter  
by passing it along to a friend

## CONNECTIONS

### Contact Us

If you would like to visit and discover more about Kendal-Crosslands Communities, we look forward to hearing from you!

**Michele Berardi** Director Marketing and Community Outreach, mberardi@kal.kendal.org, 484-259-1751

**Amy Carr** Admissions Associate, acarr@xlands.kendal.org, 484-259-0077

**Connie Dilley** Executive Assistant, Kendal at Longwood, cdilley@kal.kendal.org, 610-388-5502

**Ellen Evans** Executive Assistant, Crosslands, eevans@xlands.kendal.org, 610-388-5613

**Kelley Gusler** Move-In Coordinator, kgusler@xlands.kendal.org, 610-388-3046

**Kelley Metcalf-Hollinger** Admissions Associate, khollinger@xlands.kendal.org, 610-388-3045

**Nancy Regenye** Director of Admissions, nregenye@xlands.kendal.org, 610-388-5565